

# BROOKLYN HOUSE OF DETENTION FOR MEN

275 ATLANTIC AVE., BROOKLYN I, N.Y.

HON. ROBERT F. WAGNER, MAYOR

DEPARTMENT OF PUBLIC WORKS  
F. H. ZURMUHLEN, P. E., R. A., COMMISSIONER

DEPARTMENT OF CORRECTION  
ANNA M. KROSS, COMMISSIONER

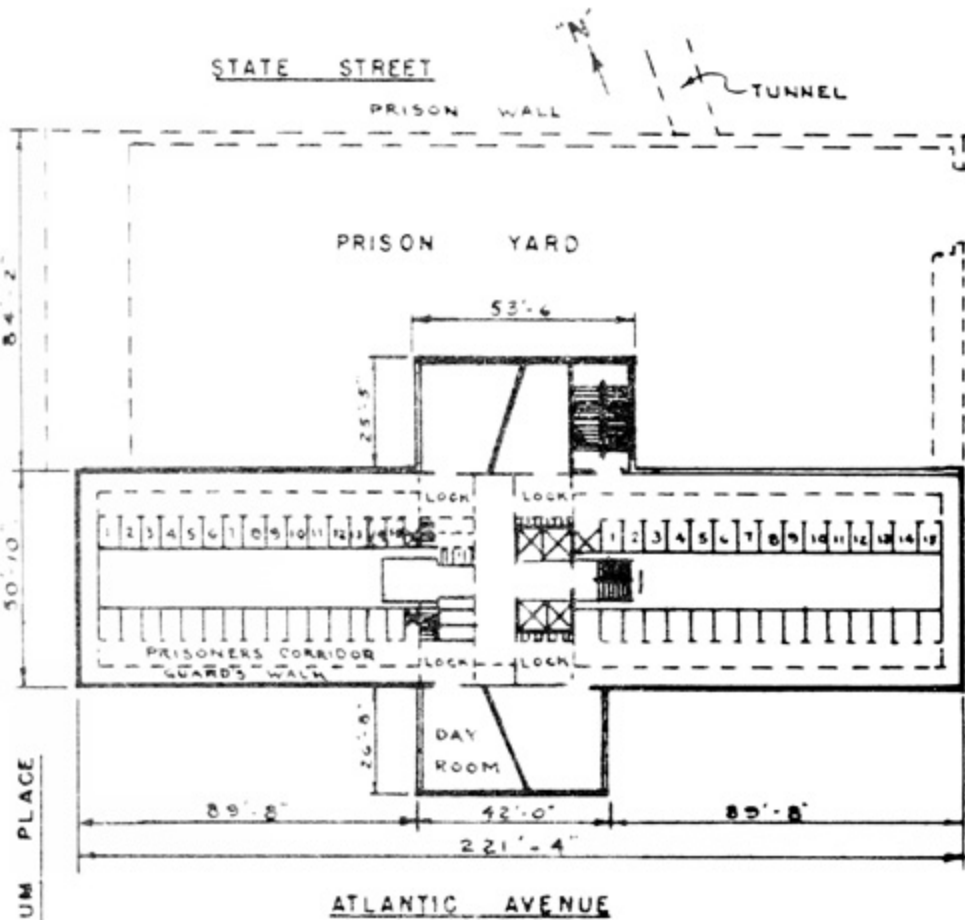

**TYPICAL PLAN**  
( 4, 5, 6, 7, 8 & 9<sup>th</sup> FL.)

## TYPICAL FLOOR

- 8 TIERS, 15 CELLS EACH
- 1 SHOWER FOR EACH TIER
- 4 DAY ROOMS
- 1 OFFICER'S TOILET & OFFICE
- 1 PANTRY
- 1 LINEN & BLANKET STORAGE ROOM
- 1 INTERVIEW ROOM
- 1 BARBER SHOP

## TYPICAL CELL

- WIDTH 5'-8"
- DEPTH 7'-10"
- HEIGHT 7'-11" (FLATS)
- HEIGHT 8'-5" (MEZZ.)

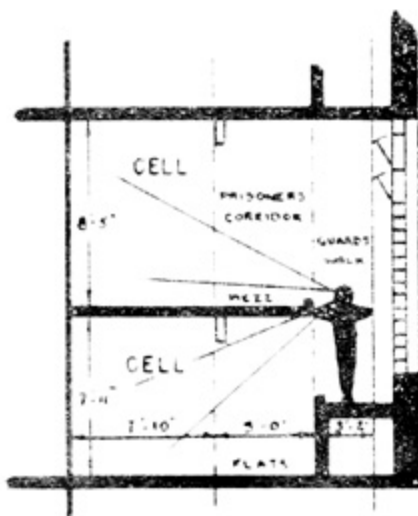

**TYPICAL SECTION**  
**THRU CELLS**

## FLOOR

- 11th — 2 OUTDOOR ROOF RECREATION AREAS (wire mesh covering) — MEDICAL AND DENTAL CLINICS — CHAPEL (204)
- 10th — 59 CELLS — 2 DAY ROOMS — 2 SEGREGATION CELLS — LIBRARY & STUDY — GYMNASIUM — MECHANICAL SPACE
- 9th — 120 CELLS — 4 DAY ROOMS
- 8th — 120 CELLS — 4 DAY ROOMS
- 7th — 120 CELLS — 4 DAY ROOMS
- 6th — 120 CELLS — 4 DAY ROOMS
- 5th — 120 CELLS — 4 DAY ROOMS
- 4th — 120 CELLS — 4 DAY ROOMS
- 3rd — KITCHEN — EMPLOYEES DINING ROOM — 2 DAY ROOMS — PRISON HELP DINING ROOM — 36 CELLS
- 2nd — SOCIAL SERVICE — GENERAL OFFICE — FAMILY VISITING — LIBRARY
- 1st — C. O. & CAPTAIN LOCKER ROOMS — DEP. WARDEN'S OFFICE — CONTROL ROOM — LAWYERS VISITS — RECEPTION AREA — GENERAL OFFICE — WARDEN'S OFFICE
- BASEMENT — PISTOL RANGE — MAINTENANCE SHOPS — STOREROOM — MECHANICAL SPACE — LAUNDRY — COMMISSARY — COURT TUNNEL

GRAND TOTAL ..... 817 Cells

Architects — Alfred Hopkins and Associates — Lester S. La Pierre and Clarence B. Litchfield.